

# Script to create & edit classic drawers

by Tobias Nagel

## **What it does:**

- It creates / edits classic drawers with grooved / rebated sides to accommodate the bottom. The front and back sits in between the sides.

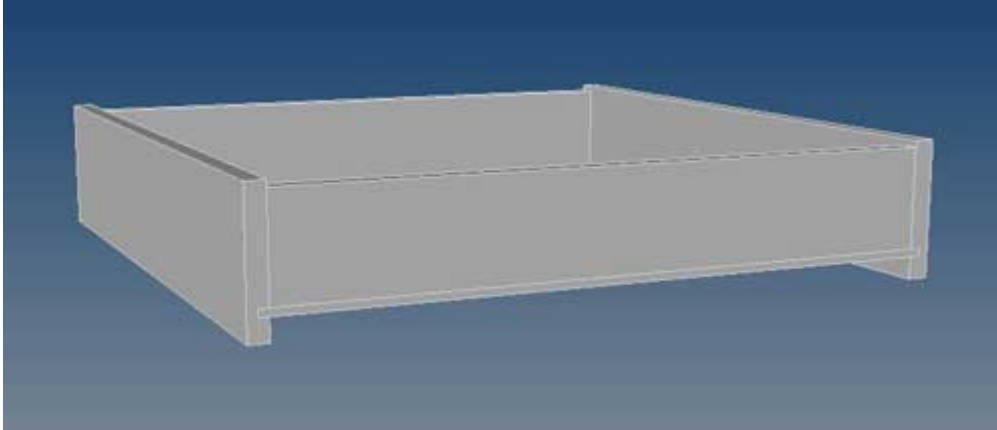

- All measurements are calculated based on the available space inside the cabinet and material and drawer rail thickness.
- Drawers will be created on a layer called \_Drawers. You can change the layer color and name afterwards, it won't affect the script.
- The script works with groups. Once you ungroup a drawer you won't be able to edit it any more

## **Note:**

- The script just works with millimetres only!!
- It doesn't work with custom construction-planes!

## **Installation:**

Just load the drawer.tb toolbar and your done. The scripts are saved behind the button

## How to use it:

When left-clicking the drawer button  you will be asked to select 3 points.

Base point 1 = The lowest point on the front and left side of the cabinet

Base point 2 = The lowest point on the front and right side of the cabinet

Base point 3 = The available depth in the cabinet

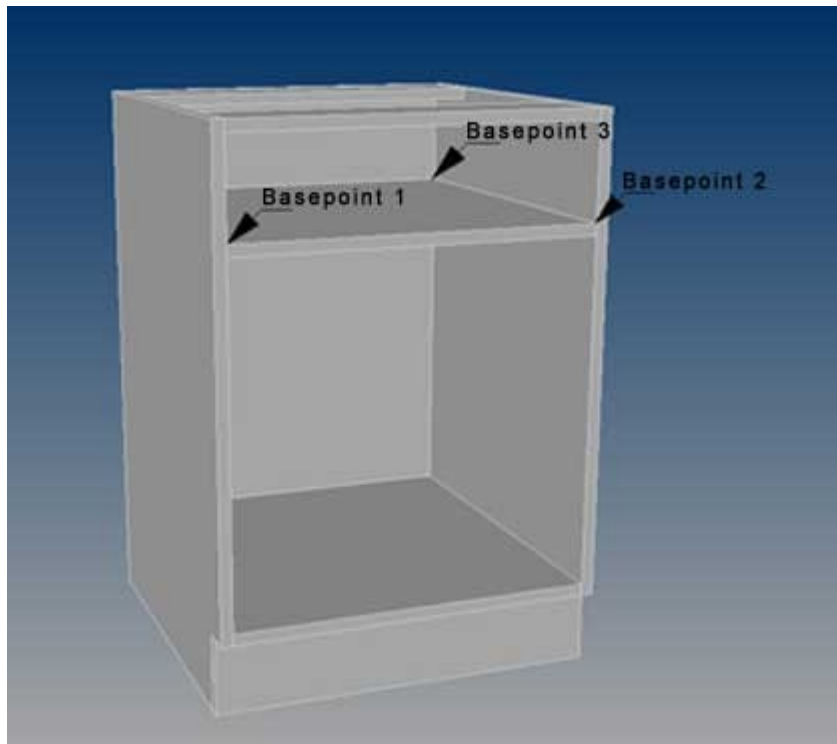

Next you're asked to adjust the drawer settings:

Create Drawer	
Settings:	
Sides height	110
Drawer Length (cabinet= 591mm)	550
Sides material thickness	16
Bottom material thickness	6
Rail clearance (total)	10
Clearance underneath bottom	18
Groove depth	8
Offset front / back to sides	5
Z+ clearance from basepoint	5
<div>OK Cancel</div>	

The rail thickness has to be the total of both sides (like in this case for a Quad-Bearing-system 5mm on both sides - the rail clearance has to be set to 10mm)

Z+ clearance from basepoint means how much the drawer has to move up from the selected basepoints

When you click Ok the drawer will be created:

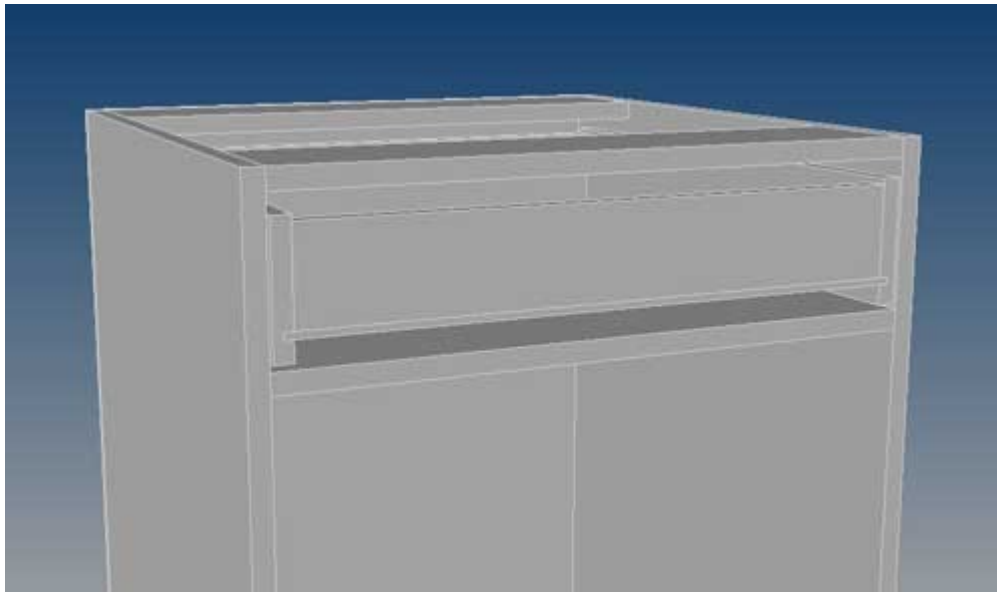

### How to edit an existing drawer:

Right-click the drawer button  and select the drawer to update.

Adjust the settings and click Ok.

**Tip:** You can set your own default settings by editing the values at the beginning of the script.

Shift-Right-click the drawer button  and set your preferences in the left pane.

